

ETCH PRIMER 2 PACK - BASE BR SPEC 81 ITEM 104A
 ACID BR SPEC 81 ITEM 104B
 TOP COAT - MICACEOUS IRON OXIDE LIGHT GREY
 BR SPEC 70 ITEM 27A

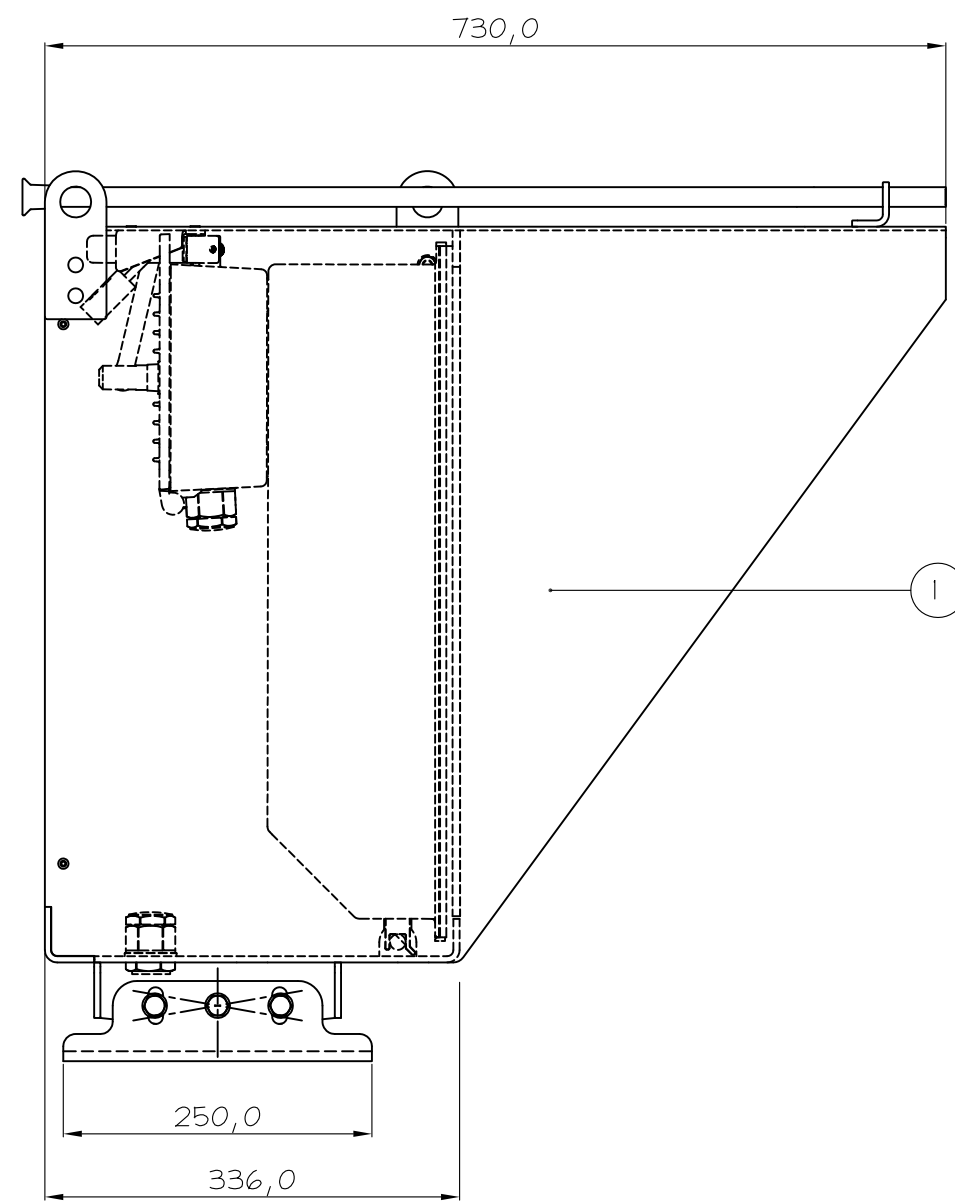

| ITEM | QTY | PART N° | DESCRIPTION |
|------|-----|------------------|-----------------------------------|
| 1 | 1 | D82.81034 | HOOD & BASE ASSEMBLY - ALUMINIUM. |
| 2 | 1 | D82.81645 | INNER ENCLOSURE ASSEMBLY. |
| 3 | 1 | PADS 0086/029003 | RKB221 PADLOCK |

OVERALL WEIGHT 35 KGS

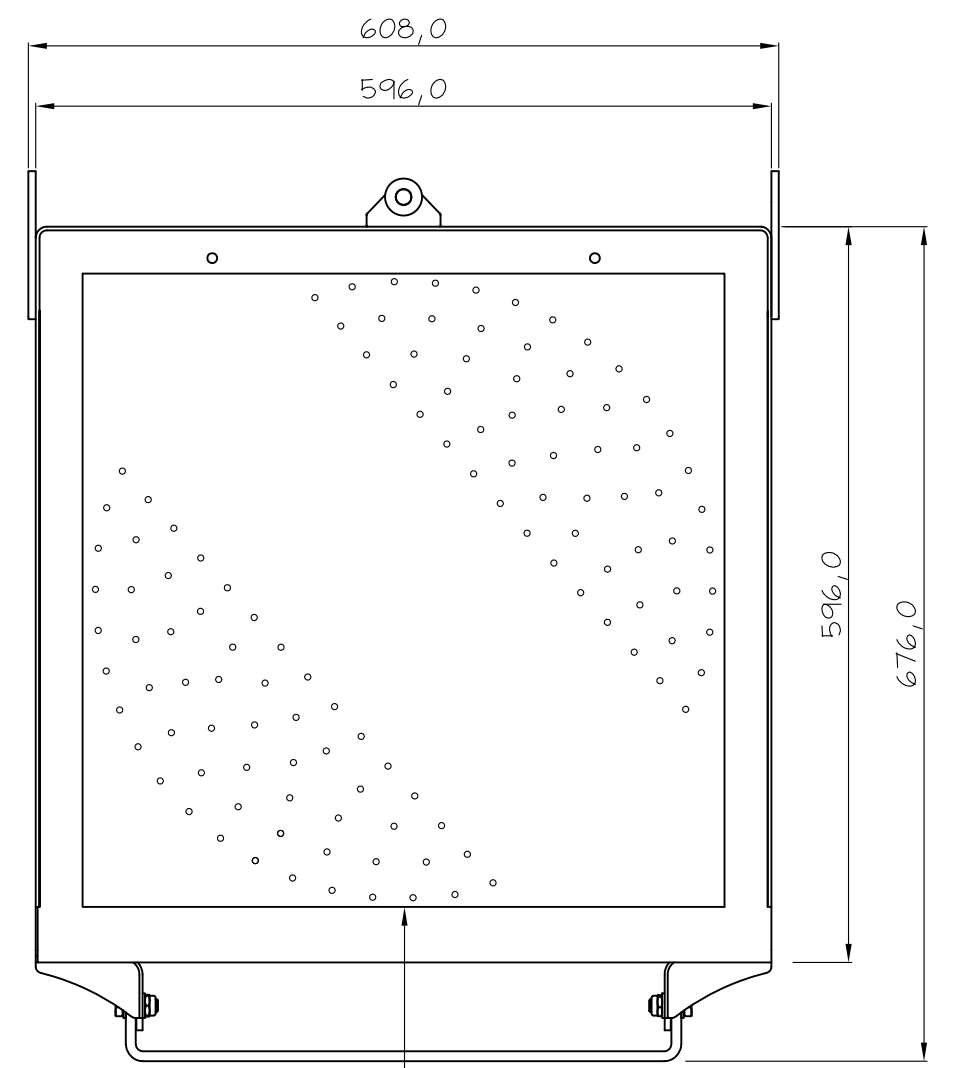

FRONT HALF OF HOOD TO BE PAINTED INSIDE AND ALL OF OUTSIDE TO THE FOLLOWING PAINT SPECIFICATION:-
 ETCH PRIMER 2 PACK - BASE BR SPEC 81 ITEM 104A
 ACID BR SPEC 81 ITEM 104B
 TOP COAT - MICACEOUS IRON OXIDE MATT BLACK BR SPEC 70 ITEM 30

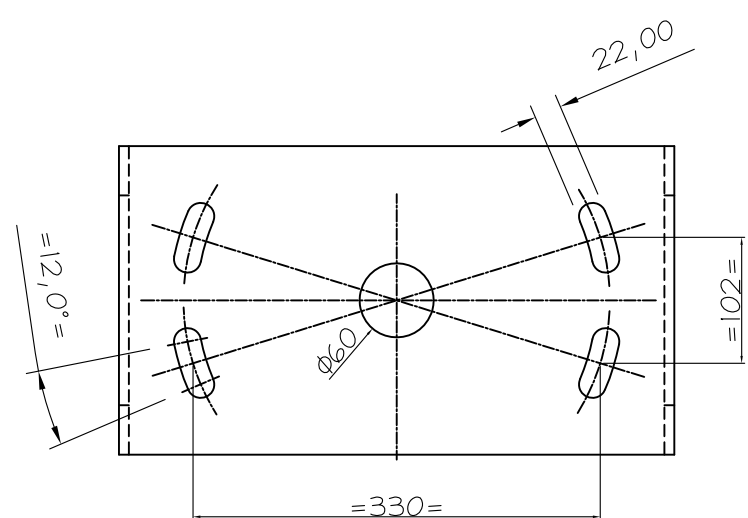

MOUNTING PLATE FIXINGS TO SUIT
 BRITISH RAIL STANDARD DESIGN
 ADAPTOR PLATE REF. BRS SM 2076



ALL DIMENSIONS IN mm UNLESS OTHERWISE STATED

DORMAN REF No. T/BANNERGRN-/15
 CUSTOMER REF No.

PRODUCT ACCEPTANCE No. TBA

| ISS | DATE | INI | ALTERATIONS |
|-----|----------|-----|------------------|
| 2 | 02/12/08 | MD | SEE DCC No. 4124 |
| 1 | 23/04/08 | MD | SEE DCC No. 4142 |
| 0 | 11/07/07 | MD | DCC No. 3673 |



SOUTHPORT PR9 8LA ENGLAND

| TITLE | | PROJECT No. 122 | |
|--|-------------|-------------------------|---------------|
| LED THREE ASPECT BANNER INDICATOR ASSEMBLY | | THIRD ANGLE PROJ | |
| MATERIAL | | Document N° 0122-7328-1 | |
| X | TOLERANCES | DRAWN MD | |
| X,0 | + / - 0,25 | CHECKED IW AUTH. IW | |
| X,00 | + / - 0,10 | DATE | 12/07/2007 |
| X,000 | + / - 0,05 | SCALE | NTS |
| ANGULAR | + / - 0,25° | SHEET | 1 OF 1 SHEETS |

THIS DOCUMENT AND THE INFORMATION THEREIN IS CONFIDENTIAL AND MAY NOT BE USED OR DISCLOSED WITHOUT WRITTEN AUTHORIZATION
 DRAWING No PART No.
 086/001339

DO NOT SCALE